



# **THE COUNTY GOVERNMENT OF LAMU**



## **TENDER DOCUMENT FOR NDAU WATER SUPPLY PROJECT**

**TENDER NO. CGL/NDAU WATER SUPPLY/ONT/018/2019-2020  
(RE- TENDERED)**

**(NEGOTIATION NUMBER 781296)**

**TENDER NO. CGL/NDAU WATER SUPPLY/ONT/018/2019-2020**

## **TABLE OF CONTENTS**

	<b>PAGE</b>
INTRODUCTION .....	1
SECTION I            INVITATION FOR TENDERS .....	3
SECTION II           INSTRUCTIONS TO TENDERERS .....	6
SECTION III          CONDITIONS OF CONTRACT .....	17
APPENDIX TO CONDITIONS OF CONTRACT .....	28
SECTION IV           SPECIFICATIONS, DRAWINGS AND BILLS OF QUANTITIES/SCHEDULE OF RATES.....	30
SECTION V            STANDARD FORMS .....	35

**SECTION I**  
**21<sup>st</sup> February, 2020**

**INVITATION FOR TENDERS**

Tender reference: **TENDER NO. CGL/ NDAU WATER SUPPLY/ONT/018/2019-2020 (RE-TENDERED).**

**Tender Name: NDAU WATER PROJECT**

- 1.1 The County Government of Lamu invites sealed tenders for the **NDAU WATER PROJECT.**
- 1.2 Interested eligible candidates may obtain further information and inspect tender documents from the Supply Chain Management office **COUNTY GOVERNMENT OF LAMU HEADQUARTERS** at White House during normal working hours or visit our website at [www.lamu.go.ke](http://www.lamu.go.ke).
- 1.3 A complete set of tender documents may be obtained by interested candidates upon payment of non-refundable fees of (Kshs.1, 000.00) in cash or Bankers Cheque payable to **COUNTY GOVERNMENT OF LAMU, Kenya Commercial Bank – Lamu Branch, Acc NO. 1140750615 or Equity Bank – Lamu Branch Acc. No. 1590265264918** Complete set of documents can also be downloaded from our website at [www.lamu.go.ke](http://www.lamu.go.ke) free of charge.
- 1.4 Prices quoted should be net inclusive of all taxes, must be in Kenya shillings and shall remain valid for 120 days from the closing date of tender.
- 1.5 Completed tender documents are to be addressed to **(COUNTY GOVERNMENT OF LAMU P.O BOX 74- 80500 LAMU and should be submitted electronically through IFMIS supplier portal at [www.supplier.treasury.go.ke](http://www.supplier.treasury.go.ke)** so as to be received on or before **Monday 09<sup>th</sup> March, 2020 at 11.00 a.m.**
- 1.6 Tenders will be opened immediately thereafter in the presence of the candidates or their representatives who choose to attend at Supply Chain Management Office at White House, 2<sup>nd</sup> Floor, Located at County Headquarters at Mokowe

*For (Accounting Officer/County Government of Lamu*

**TENDER NO. CGL/NDAU WATER SUPPLY/ONT/018/2019-2020**

**SECTION II**  
**INSTRUCTIONS TO TENDERERS**

**TABLE OF CONTENTS**

<b>CLAUSE</b>	<b>PAGE.</b>
1. GENERAL -----	5
2.TENDER DOCUMENTS -----	5
3.PREPARATION OF TENDERS -----	67
4.SUBMISSION OF TENDERS -----	7
5.TENDER OPENING AND EVALUATON -----	8
6.AWARD OF CONTRACT -----	10

**INSTRUCTIONS TO TENDERERS.**

- 1.1 COUNTY GOVERNMENT OF LAMU as defined in the Appendix to Conditions of Contract invites tenders for Works Contract as described in the tender documents and should complete the Works by the Intended Completion Date specified in the said Appendix.

- 1.2Tenderers shall include the following information and documents with their tenders, unless otherwise stated:
- 1.3The Tenderer shall bear all costs associated with the preparation and submission of his tender, and COUNTY GOVERNMENT OF LAMU will in no case be responsible or liable for those costs.
- 1.4The Tenderer, at the Tenderer's own responsibility and risk, is encouraged to visit and examine the Site of the Works and its surroundings, and obtain all information that may be necessary for preparing the tender and entering into a contract for construction of the Works. The costs of visiting the Site shall be at the Tenderer's own expense.
- 1.5The procurement entity's employees, committee members, board members and their relative (spouse and children) are not eligible to participate in the tender.
- 1.6 The price to be charged for the tender document shall not exceed Kshs.5, 000/=
- 1.7The County Government of Lamu shall allow the tenderer to review the tender document free of charge before purchase.

## **2. Tender Documents**

- 2.1The complete set of tender documents comprises the documents listed here below and any addenda issued in accordance with clause 2.4 here below:-
- (a) These instructions to Tenderers
  - (b) Form of Tender
  - (c) Conditions of Contract and Appendix to Conditions of Contract
  - (d) Specifications
  - (e) Drawings
  - (f) Bills of Quantities/Schedule of Rates (whichever is applicable)
  - (g) Other materials required to be filled and submitted in accordance with these Instructions and Conditions
- 2.2 The Tenderer shall examine all instructions, forms and specifications in the tender documents. Failure to furnish all information required by the tender documents may result in rejection of his tender.
- 2.3 Prospective Tenderer making inquiries of the tendering documents may notify County Government of Lamu in writing or by cable, telex or facsimile at the

address indicated in the letter of invitation to tender. County Government of Lamu will respond to any request for clarification received earlier than seven [7] days prior to the deadline for submission of tenders. Copies of the County Government of Lamu response will be forwarded to all persons issued with tendering documents, including a description of the inquiry, but without identifying its source.

- 2.4 Before the deadline for submission of tenders, County Government of Lamu may modify the tendering documents by issuing addenda. Any addendum thus issued shall be part of the tendering documents and shall be communicated in writing or by cable, telex or facsimile to all Tenderers. Prospective Tenderers shall acknowledge receipt of each addendum in writing to the County Government of Lamu
- 2.5 To give prospective Tenderers reasonable time in which to take an addendum into account in preparing their tenders, County Government of Lamu shall extend, as necessary, the deadline for submission of tenders in accordance with clause 4.2 here below.

### **3. Preparation of Tenders**

- 3.1 All documents relating to the tender and any correspondence shall be in English Language.
- 3.2 The tender submitted by the Tenderer shall comprise the following:-
  - (a) The Tender;
  - (b) Tender Security;
  - (c) Priced Bill of Quantities/Schedule of Rates for lump-sum Contracts
  - (d) Any other materials required to be completed and submitted by Tenderers.
- 3.3 The Tenderer shall fill in rates and prices for all items of the Works described in the Bill of Quantities/Schedule of Rates. Items for which no rate or price is entered by the Tenderer will not be paid for when executed and shall be deemed covered by the other rates and prices in the Bill of Quantities/Schedule of Rates. All duties, taxes and other levies payable by the Contractor under the Contract, as of 30 days prior to the deadline for submission of tenders, shall be included in the tender price submitted by the Tenderer.

- 3.4 The rates and prices quoted by the Tenderer shall not be subject to any adjustment in the initial 12 months period during the performance of the Contract.
- 3.5 The unit rates and prices shall be in Kenya Shillings.
- 2.6 Tenders shall remain valid for a period of one hundred and twenty (120) days from the date of submission. However in exceptional circumstances, the County Government of Lamu may add additional period. The request and the Tenderers' responses shall be made in writing.
- 3.6 The Tenderer shall prepare one original and one copy of the documents comprising the tender documents as described in these Instructions to Tenderers.
- 3.7 The original shall be typed or written in indelible ink and shall be signed by a person or persons duly authorized to sign on behalf of the Tenderer. All pages of the tender where alterations or additions have been made shall be initialed by the person or persons signing the tender.
- 3.8 Clarification of tenders shall be requested by the tenderer to be received by COUNTY GOVERNMENT OF LAMU not later than 7 days prior to the deadline for submission of tenders.
- 3.9 The County Government of Lamu shall reply to any clarifications sought by the tenderer within 3 days of receiving the request to enable the tenderer to make timely submission of its tender.

#### **4. Submission of Tenders**

- 4.1 The tender duly filled and sealed in an envelope shall;-
- (a) be addressed to the County Government of Lamu at the address provided in the invitation to tender;
- [b] Bear the name and identification number of the Contract/tender number as defined in the invitation to tender; and
- [c] Provide a warning not to open before the specified time and date for tender opening.

4.2 Tenders shall be delivered to COUNTY GOVERNMENT OF LAMU at the address specified above not later than the time and date specified in the invitation to tender.

4.3 The tenderer shall not submit any alternative offers unless they are specifically required in the tender documents.

Only one tender may be submitted by each tenderer. Any tenderer who fails to comply with this requirement will be disqualified.

4.4 Any tender received after the deadline for opening tenders will be returned to the tenderer un-opened.

4.5 COUNTY GOVERNMENT OF LAMU may extend the deadline for submission of tenders by issuing an amendment in accordance with sub-clause 2.5 in which case all rights and obligations of COUNTY GOVERNMENT OF LAMU and the Tenderers previously subject to the original deadline will then be subject to the new deadline.

4.6 Tender security SHALL be in the equivalent of 2% of the total tender amount. Any bidder providing a bid bond less than the required amount will be disqualified. And be in cash, banker's cheque, Insurance or any other form easily convertible.

## **5. Tender Opening and Evaluation**

5.1 The tenders will be opened in the presence of the Tenderers' representatives who choose to attend on **Monday 09<sup>th</sup> March, 2020 at 11.00 a.m.**

5.2 The Tenderers' names, the total amount of each tender and such other details as may be considered appropriate, will be announced at the opening by the COUNTY GOVERNMENT OF LAMU. Minutes of the tender opening, including the information disclosed to those present will also be prepared by COUNTY GOVERNMENT OF LAMU

5.3 Information relating to the examination, clarification, evaluation and comparison of tenders and recommendations for the award of the Contract shall not be disclosed to Tenderers or any other persons not officially concerned with such process until the award to the successful Tenderer has been announced. Any effort by a Tenderer to influence the COUNTY GOVERNMENT OF LAMU officials, processing of tenders or award decisions may result in the rejection of his tender.



5.4Tenders determined to be substantially responsive will be accepted. As provided under section 82 of the Public Procurement and Asset Disposal Act, 2015, There SHALL be no correction of errors.

5.5The tender evaluation committee shall evaluate the tender within 30 days of the validity period from the date of opening the tender.

5.6Contract price variations shall not be allowed for contracts not exceeding one year (12 months)

5.7Where contract price variation is allowed, the cumulative value for all contract do not result in an increment of the total contract price by more than twenty five (25%) of the original contract price, and SHALL be considered after 12 months from the date of contract signing, and shall be executed within the period of the contract.

5.8Price variation requests shall be processed by COUNTY GOVERNMENT OF LAMU within 30 days of receiving the request.

5.9Exclusive Preference SHALL be given to citizens of Kenya where the funding is 100% from the National Government or County Government or a Kenyan Body and the amount prescribed SHALL be above five hundred million.

5.10To assist in the examination, evaluation, and comparison of tenders, the COUNTY GOVERNMENT OF LAMU at his discretion, may request [in writing] any Tenderer for clarification of the tender, including breakdowns of unit rates. The request for clarification and the response shall be in writing or by cable, telex or facsimile but no change in the tender price or substance of the tender shall be sought, offered or permitted.

5.11The Tenderer shall not influence COUNTY GOVERNMENT OF LAMU on any matter relating to his tender from the time of the tender opening to the time the Contract is awarded. Any effort by the Tenderer to influence COUNTY GOVERNMENT OF LAMU or his employees in his decision on tender evaluation, tender comparison or Contract award may result in the rejection of the tender.

## **6. Award of Contract**

6.1The award of the Contract will be made to the Tenderer who has offered the most competitive bid and who will be determined to be the highest combined scorer.

6.2 Notwithstanding the provisions of clause 6.1 above, COUNTY GOVERNMENT OF LAMU reserves the right to accept or reject any tender and to cancel the tendering process and reject all tenders at any time prior to the award of Contract without thereby

incurring any liability to the affected Tenderer or Tenderers or any obligation to inform the affected Tenderer or Tenderers of the grounds for the action.

6.3The Tenderer whose tender has been accepted will be notified of the award prior to expiration of the tender validity period in writing or by cable, telex or facsimile. This notification (hereinafter and in all Contract documents called the “Letter of Acceptance”) will state the sum [hereinafter and in all Contract documents called the “Contract Price” which COUNTY GOVERNMENT OF LAMU will pay the Contractor in consideration of the execution, completion, and maintenance of the Works by the Contractor as prescribed by the Contract. The contract shall be formed on the parties signing the contract. At the same time the other tenderers shall be informed that their tenders have not been successful.

6.4The Contract Agreement will incorporate all agreements between COUNTY GOVERNMENT OF LAMU and the successful Tenderer. It will be signed by the County and sent to the successful Tenderer, within 30 days following the notification of award. Within 30 days of receipt, the successful Tenderer will sign the Agreement and return it to COUNTY GOVERNMENT OF LAMU

6.5Within 14 days after receipt of the Letter of Acceptance, the successful Tenderer shall deliver to COUNTY GOVERNMENT OF LAMU a Performance Security equivalent to 10% of the tender amount as stipulated in the Appendix to Conditions of Contract.

6.6The parties to the contract shall have it signed within 30 days from the date of notification of contract award unless there is an administrative review request.

6.7 COUNTY GOVERNMENT OF LAMU may at any time terminate procurement proceedings before contract award and shall not be liable to any person for the termination.

6.8 COUNTY GOVERNMENT OF LAMU shall give prompt notice of the termination to the tenderers and (on request) shall give its reasons for termination within 14 day of receiving the request from any tenderer.

## **7. Corrupt and fraudulent practices**

7.1 COUNTY GOVERNMENT OF LAMU requires that the tenderer observes the highest standard of ethics during the procurement process and execution of the contract. A tenderer shall sign a declaration that he has not and will not be involved in corrupt and fraudulent practices.

7.2 COUNTY GOVERNMENT OF LAMU will reject a tender if it determines that the tenderer recommended for award has engaged in corrupt and fraudulent practices in competing for the contract in question.

7.3 Further a tenderer who is found to have indulged in corrupt and fraudulent practices risks being debarred from participating in public procurement in Kenya.

## **APPENDIX TO INSTRUCTIONS TO TENDERERS**

**TENDER NO. CGL/NDAU WATER SUPPLY/ONT/018/2019-2020**

**PAGE12**

<b>Instruction to tender reference</b>	<b><i>Particulars of Appendix to instructions to tenderers</i></b>
1.4	Validity of tenders (120 days).
1.5	Place/ venue for tender opening.
1.6	The price to be charged for the tender document shall be <b>Kshs. 1,000.00</b>
4.6 Tender Security	Shall be 2% of the total tender amount from a reputable bank or insurance companies approved by PPRA.
3.7 Number of Tender Copies Required	To be submitted electronically.
5.1 State day, date and time of tender closing	Tenders will open on <b>Monday 09<sup>th</sup> March, 2020 at 11.00 a.m.</b>
5.4	No correction of errors
5.9	Preference
Appendices	Bill of Quantities For NDAU water Project
<b>Site Visit</b>	<b><i>Interested bidders to undertake site visits on 25<sup>th</sup> February, 2020. Bidders to assemble at Lamu Water and Sewerage Company headquarters ( LAWASCO) at 9:30 a.m.</i></b>

### **SECTION III CONDITIONS OF CONTRACT**

<b>Table of Clauses</b>	<b>Page</b>
1. DEFINITIONS.....	17
2. CONTRACT DOCUMENTS.....	18
3. COUNTY GOVERNMENT OF LAMU’S REPRESENTATIVE’S DECISIONS.....	19
4. WORKS, LANGUAGE AND LAW OF CONTRACT.....	19
5. SAFETY, TEMPORARY WORKS AND DISCOVERIES.....	19
6. WORK PROGRAM AND SUB-CONTRACTING.....	19
7. THE SITE.....	20
8. INSTRUCTIONS.....	20
9. EXTENSION OF COMPLETION DATE.....	20
10. MANAGEMENT MEETINGS.....	21
11. DEFECTS.....	22
12. BILLS OF QUANTITIES/SCHEDULE OF RATES.....	22
13. VARIATIONS.....	23
14. PAYMENT CERTIFICATES AND FINAL ACCOUNT .....	23
15. INSURANCES.....	24
16. LIQUIDATED DAMAGES.....	24
17. COMPLETION AND TAKING OVER.....	25
18. TERMINATION.....	25
19. PAYMENT UPON TERMINATION.....	26

20.	CORRUPT GIFTS AND PAYMENTS OF COMMISSION.....	26
21.	SETTLEMENT OF DISPUTES.....	27

## SECTION III - CONDITIONS OF CONTRACT

### 1. Definitions

1.1 In this Contract, except where context otherwise requires, the following terms shall be interpreted as indicated;

**“Bills of Quantities”** means the priced and completed Bill of Quantities forming part of the tender [where applicable].

**“Schedule of Rates”** means the priced Schedule of Rates forming part of the tender [where applicable].

**“The Completion Date”** means the date of completion of the Works as certified by COUNTY GOVERNMENT OF LAMU Representative.

**“The Contract”** means the agreement entered into by COUNTY GOVERNMENT OF LAMU and the Contractor as recorded in the Agreement Form and signed by the parties.

**“The Contractor”** refers to the person or corporate body whose tender to carry out the Works has been accepted by COUNTY GOVERNMENT OF LAMU.

**“The Contractor’s Tender”** is the completed tendering document submitted by the Contractor to COUNTY GOVERNMENT OF LAMU

**“The Contract Price”** is the price stated in the Letter of Acceptance.

**“Days”** are calendar days; **“Months”** are calendar months.

**“A Defect”** is any part of the Works not completed in accordance with the Contract.

**“The Defects Liability Certificate”** is the certificate issued by COUNTY GOVERNMENT OF LAMU **Representative upon correction of defects by the Contractor.**

**“The Defects Liability Period”** is the period named in the Appendix to Conditions of Contract and calculated from the Completion Date.



**“Drawings”** include calculations and other information provided or approved by COUNTY GOVERNMENT OF LAMU’S Representative for the execution of the Contract.

**“Lamu water and Sewerage Company-COUNTY GOVERNMENT OF LAMU”** is the Water service provider in Lamu county and party who employs the Contractor to carry out the Works.

**“Equipment”** is the Contractor’s machinery and vehicles brought temporarily to the Site for the execution of the Works.

**“Site” means** the place or places where the permanent Works are to be carried out including workshops where the same is being prepared.

**“Materials” are** all supplies, including consumables, used by the Contractor for incorporation in the Works.

**“COUNTY GOVERNMENT OF LAMU’S Representative”** is the person appointed by COUNTY GOVERNMENT OF LAMU and notified to the Contractor for the purpose of supervision of the Works.

**“Specification” means** the Specification of the Works included in the Contract.

**“Start Date”** is the date when the Contractor shall commence execution of the Works.

**“A Subcontractor”** is a person or corporate body who has a Contract with the Contractor to carry out a part of the Work in the Contract, which includes Work on the Site.

**“Temporary works” are** works designed, constructed, installed, and removed by the Contractor which are needed for construction or installation of the Works.

**“A Variation”** is an instruction given by COUNTY GOVERNMENT OF LAMU Representative which varies the Works.

**“The Works” are** what the Contract requires the Contractor to construct, install, and turnover to COUNTY GOVERNMENT OF LAMU

## **2. Contract Documents**

2.1 The following documents shall constitute the Contract documents and shall be interpreted in the following order of priority;

- (1) Agreement,
- (2) Letter of Acceptance,
- (3) Contractor's/form of Tender,
- (4) Conditions of Contract,
- (5) Specifications,
- (6) Drawings,
- (7) Bills of Quantities or Schedule of Rates [whichever is applicable]
- (8) Performance guarantee

### **3. COUNTY GOVERNMENT OF LAMU'S Representative's Decisions**

3.1 Except where otherwise specifically stated, the COUNTY GOVERNMENT OF LAMU's Representative will decide contractual matters between COUNTY GOVERNMENT OF LAMU and the Contractor in the role representing COUNTY GOVERNMENT OF LAMU

### **4. Works, Language and Law of Contract**

4.1 The Contractor shall construct and install the Works in accordance with the Contract documents. The Works may commence on the Start Date and shall be carried out in accordance with the Program submitted by the Contractor, as updated with the approval of COUNTY GOVERNMENT OF LAMU's Representative, and complete them by the Intended Completion Date.

4.2 The ruling language of the Contract shall be English language and the law governing the Contract shall be the law of the Republic of Kenya.

### **5. Safety, Temporary works and Discoveries**

5.1 The Contractor shall be responsible for design of temporary works and shall obtain approval of third parties to the design of the temporary works where required.

5.2 The Contractor shall be responsible for the safety of all activities on the Site.

5.3 Any thing of historical or other interest or significant value unexpectedly discovered on the Site shall be the property of COUNTY GOVERNMENT OF LAMU. The Contractor shall notify the COUNTY GOVERNMENT OF LAMU's Representative of such discoveries and carry out COUNTY GOVERNMENT OF LAMU's Representative's instructions for dealing with them.

## **6Work Program and Sub-contracting**

- 6.1 Within seven days after Site possession date, the Contractor shall submit to the COUNTY GOVERNMENT OF LAMU's Representative for approval a program showing the general methods, arrangements, order and timing for all the activities in the Works.
- 6.2 The Contractor may sub-contract the Works (but only to a maximum of 25 percent of the Contract Price) with the approval COUNTY GOVERNMENT OF LAMU's Representative. However, he shall not assign the Contract without the approval of COUNTY GOVERNMENT OF LAMU in writing. Subcontracting shall not alter the Contractor's obligations.

## **7The site**

- 7.1 COUNTY GOVERNMENT OF LAMU shall give possession of all parts of the Site to the Contractor.
- 7.2 The Contractor shall allow COUNTY GOVERNMENT OF LAMU's Representative and any other person authorized by the COUNTY GOVERNMENT OF LAMU's Representative, access to the Site and to any place where work in connection with the Contract is being carried out or is intended to be carried out.

## **8Instructions**

- 8.1 The Contractor shall carry out all instructions of COUNTY GOVERNMENT OF LAMU's Representative which are in accordance with the Contract.

## **9Extension of Completion Date**

- 9.1 COUNTY GOVERNMENT OF LAMU's Representative shall extend the Completion Date if an occurrence arises which makes it impossible for completion to be achieved by the Intended Completion Date. COUNTY GOVERNMENT OF LAMU's Representative shall decide whether and by how much to extend the Completion Date.
- 9.2 For the purposes of this clause, the following occurrences shall be valid for consideration;

Delay by:-

- (a) force majeure, or

- (b) reason of any exceptionally adverse weather conditions, or
- (c) reason of civil commotion, strike or lockout affecting any of the trades employed upon the Works or any of the trades engaged in the preparation, manufacture or transportation of any of the goods or materials required for the Works, or
- (d) reason of COUNTY GOVERNMENT OF LAMU's Representative's instructions issued under these Conditions, or
- (e) reason of the contractor not having received in due time necessary instructions, drawings, details or levels from COUNTY GOVERNMENT OF LAMU's Representative for which he specifically applied in writing on a date which having regard to the date for Completion stated in the appendix to these Conditions or to any extension of time then fixed under this clause was neither unreasonably distant from nor unreasonably close to the date on which it was necessary for him to receive the same, or
- (f) delay on the part of artists, tradesmen or others engaged by COUNTY GOVERNMENT OF LAMU in executing work not forming part of this Contract, or
- (g) reason of delay by statutory or other services providers or similar bodies engaged directly by Lamu County or
- (h) reason of opening up for inspection of any Work covered up or of the testing or any of the Work, materials or goods in accordance with these conditions unless the inspection or test showed that the Work, materials or goods were not in accordance with this Contract, or
- (i) reason of delay in appointing a replacement COUNTY GOVERNMENT OF LAMU's Representative, or
- (j) reason of delay caused by the late supply of goods or materials or in executing Work for which COUNTY GOVERNMENT OF LAMU or his agents are contractually obliged to supply or to execute as the case may be, or
- (k) Delay in receiving possession of or access to the Site.

## **10 Management Meetings**

- 10.1A Contract management meeting shall be held regularly and attended by COUNTY GOVERNMENT OF LAMU's Representative and the Contractor. Its business shall be to review the plans for the remaining Work. COUNTY GOVERNMENT OF LAMU's Representative shall record the business of management meetings and provide copies of the record to those attending the meeting and COUNTY GOVERNMENT OF LAMU. The responsibility of the parties for actions to be taken shall be decided by COUNTY GOVERNMENT OF LAMU's Representative either at the management meeting or after the management meeting and stated in writing to all who attend the meeting.
- 10.2 Communication between parties shall be effective only when in writing.

## **11 Defects**

- 11.1 COUNTY GOVERNMENT OF LAMU's Representative shall inspect the Contractor's work and notify the Contractor of any defects that are found. Such inspection shall not affect the Contractor's responsibilities. The COUNTY GOVERNMENT OF LAMU's representative may instruct the Contractor to search for a defect and to uncover and test any Work that COUNTY GOVERNMENT OF LAMU may considers to have a defect. Should the defect be found, the cost of uncovering/ and making well shall be borne by the Contractor. However if there is no defect found, the cost of uncovering and making good shall be treated as a variation and added to the Contract Price.
- 11.2 COUNTY GOVERNMENT OF LAMU's Representative shall give notice to the Contractor of any defects before the end of the Defects Liability Period, which begins at Completion, and is defined in the Appendix to Conditions of Contract.
- 11.3 Every time notice of a defect is given, the Contractor shall correct the notified defect within the length of time specified by COUNTY GOVERNMENT OF LAMU's Representative's notice. If the Contractor has not corrected a defect within the time specified in COUNTY GOVERNMENT OF LAMU's Representative's notice, COUNTY GOVERNMENT OF LAMU's Representative will assess the cost of having the defect corrected by other parties and such cost shall be treated as a variation and be deducted from the Contract Price.

## **12 Bills of Quantities/Schedule of Rates**

12.1 The Bills of Quantities/Schedule of Rates shall contain items for the construction, installation, testing and commissioning of the Work to be done by the Contractor. The Contractor will be paid for the quantity of the Work done at the rates in the Bills of Quantities/Schedule of Rates for each item. Items against which no rate is entered by the Tenderer will not be paid for when executed and shall be deemed covered by the rates for other items in the Bills of Quantities/Schedule of Rates.

12.2 Where Bills of Quantities do not form part of the Contract, the Contract Price shall be a lump sum (which shall be deemed to have been based on the rates in the Schedule of Rates forming part of the tender) and shall be subject to re-measurement after each stage.

### **13 Variations**

13.1 The Contractor shall provide COUNTY GOVERNMENT OF LAMU's Representative with a quotation for carrying out the variations when requested to do so. The COUNTY GOVERNMENT OF LAMU's Representative shall assess the quotation and shall obtain the necessary authority from COUNTY GOVERNMENT OF LAMU before the variation is ordered.

13.2 If the Work in the variation corresponds with an item description in the Bill of Quantities/Schedule of Rates, the rate in the Bill of Quantities/Schedule of Rates shall be used to calculate the value of the variation. If the nature of the Work in the variation does not correspond with items in the Bill of Quantities/Schedule of Rates, the quotation by the Contractor shall be in the form of new rates for the relevant items of Work.

13.3 If the Contractor's quotation is unreasonable, COUNTY GOVERNMENT OF LAMU's Representative may order the variation and make a change to the Contract Price, which shall be based on COUNTY GOVERNMENT OF LAMU's Representative's own forecast of the effects of the variation on the Contractor's costs.

### **14 Payment Certificates and Final Account**

14.1 The Contractor shall be paid after each of the following stages of Work listed here below (subject to re-measurement by COUNTY GOVERNMENT OF LAMU's Representative of the Work done in each stage before payment is made). In case of lump-sum Contracts, the valuation for each stage shall be based on the quantities so obtained in the re-measurement and the rates in the Schedule of Rates.

- (i) Advance payment \_\_\_\_\_ (*percent of Contract Price, [after Contract execution] to be inserted by the County Government of Lamu*).
  - (ii) First stage (*define stage*) \_\_\_\_\_
  - (iii) Second stage (*define stage*) \_\_\_\_\_
  - (iv) Third stage (*define stage*) \_\_\_\_\_
  - (v) After defects liability period.
- 14.2 Upon deciding that Works included in a particular stage are complete, the Contractor shall submit to the COUNTY GOVERNMENT OF LAMU's Representative his application for payment. The COUNTY GOVERNMENT OF LAMU's Representative shall check, adjust if necessary and certify the amount to be paid to the Contractor within 21 days of receipt of the Contractor's application. COUNTY GOVERNMENT OF LAMU shall pay the Contractor the amounts so certified within 30 days of the date of issue of each Interim Certificate.
- 14.3 The Contractor shall supply COUNTY GOVERNMENT OF LAMU's Representative with a detailed final account of the total amount that the Contractor considers payable under the Contract before the end of the Defects Liability Period. COUNTY GOVERNMENT OF LAMU's Representative shall issue a Defect Liability Certificate and certify any final payment that is due to the Contractor within 30 days of receiving the Contractor's account if it is correct and complete. If it is not, COUNTY GOVERNMENT OF LAMU's Representative shall issue within 21 days a schedule that states the scope of the corrections or additions that are necessary. If the final account is still unsatisfactory after it has been resubmitted, the COUNTY GOVERNMENT OF LAMU's Representative shall decide on the amount payable to the Contractor and issue a Final Payment Certificate. COUNTY GOVERNMENT OF LAMU shall pay the Contractor the amount so certified within 60 days of the issue of the Final Payment Certificate.
- 14.4 If the period laid down for payment to the Contractor upon each of the COUNTY GOVERNMENT OF LAMU's Representative's Certificate by COUNTY GOVERNMENT OF LAMU has been exceeded, the Contractor shall be entitled to claim simple interest calculated pro-rata on the basis of the number of days delayed at the

Central Bank of Kenya's average base lending rate prevailing on the first day the payment becomes overdue. The Contractor will be required to notify COUNTY GOVERNMENT OF LAMU within 15 days of receipt of delayed payments of his intentions to claim interest.

## **15. Insurance**

15.1 The Contractor shall be responsible for and shall take out appropriate cover against, among other risks, personal injury; loss of or damage to the Works, materials and plant; and loss of or damage to property.

## **16. Liquidated Damages**

16.1 The Contractor shall pay liquidated damages to COUNTY GOVERNMENT OF LAMU at the rate 0.001 per cent of the Contract price per day for each day that the actual Completion Date is later than the Intended Completion Date except in the case of any of the occurrences listed under clause 9.2. COUNTY GOVERNMENT OF LAMU may deduct liquidated damages from payments due to the Contractor. Payment of liquidated damages shall not affect the Contractor's liabilities.

## **17. Completion and Taking Over**

17.1 Upon deciding that the Work is complete the Contractor shall request the COUNTY GOVERNMENT OF LAMU's Representative to issue a Certificate of Completion of the Works, upon deciding that the Work is completed.

COUNTY GOVERNMENT OF LAMU shall take over the Site and the Works within seven days of the COUNTY GOVERNMENT OF LAMU's Representative issuing a Certificate of Completion.

## **18. Termination**

18.1 COUNTY GOVERNMENT OF LAMU or the Contractor may terminate the Contract if the other party causes a fundamental breach of the Contract. These fundamental breaches of Contract shall include, but shall not be limited to, the following;

- (a) the Contractor stops Work for 30 days continuously without reasonable cause or authority from COUNTY GOVERNMENT OF LAMU's Representative;



- (b) the Contractor is declared bankrupt or goes into liquidation other than for a reconstruction or amalgamation;
- (c) A payment certified by COUNTY GOVERNMENT OF LAMU's Representative is not paid by COUNTY GOVERNMENT OF LAMU to the Contractor within 30 days after the expiry of the payment periods stated in sub clauses 14.2 and 14.3 hereinabove.
- (d) COUNTY GOVERNMENT OF LAMU's Representative gives notice that failure to correct a particular defect is a fundamental breach of Contract and the Contractor fails to correct it within a reasonable period of time.

18.2 If the Contract is terminated, the Contractor shall stop Work immediately, and leave the Site as soon as reasonably possible. COUNTY GOVERNMENT OF LAMU's Representative shall immediately thereafter arrange for a meeting for the purpose of taking record of the Works executed and materials, goods, equipment and temporary buildings on Site.

## **19. Payment upon Termination**

19.1 COUNTY GOVERNMENT OF LAMU may employ and pay other persons to carry out and complete the Works and to rectify any defects and may enter upon the Works and use all materials on Site, plant, equipment and temporary works.

19.2 The Contractor shall, during the execution or after the completion of the Works under this clause, remove from the Site as and when required within such reasonable time as COUNTY GOVERNMENT OF LAMU's Representative may in writing specify, any temporary buildings, plant, machinery, appliances, goods or materials belonging to him, and in default thereof, COUNTY GOVERNMENT OF LAMU may (without being responsible for any loss or damage) remove and sell any such property of the Contractor, holding the proceeds less all costs incurred to the credit of the Contractor.

19.3 Until after completion of the Works under this clause, COUNTY GOVERNMENT OF LAMU shall not be bound by any other provision of this Contract to make any payment to the Contractor, but upon such completion as aforesaid and the verification within a reasonable time of the accounts therefor COUNTY GOVERNMENT OF LAMU's Representative shall certify the amount of expenses properly incurred by COUNTY GOVERNMENT OF LAMU and, if such amount added to the money paid to the Contractor before such determination exceeds the total amount which would have been payable on due completion in accordance with this Contract, the difference

shall be a debt payable to COUNTY GOVERNMENT OF LAMU by the Contractor; and if the said amount added to the said money be less than the said total amount, the difference shall be a debt payable by COUNTY GOVERNMENT OF LAMU to the Contractor.

## **20. Corrupt Gifts and Payments of Commission**

20.1 The Contractor shall not;

- (a) Offer or give or agree to give to any person in the service of COUNTY GOVERNMENT OF LAMU any gifts or consideration of any kind as an inducement or reward for doing or forbearing to do or for having done or forborne to do any act in relation to the obtaining or execution of this or any other contract with COUNTY GOVERNMENT OF LAMU or for showing or forbearing to show favour or disfavor to any person in relation to this or any other contract with COUNTY GOVERNMENT OF LAMU
- (b) Any breach of this Condition by the Contractor or by anyone employed by him or acting on his behalf (whether with or without the knowledge of the Contractor) shall be an offence under the Laws of Kenya.

## **21. Settlement of Disputes**

21.1 Any dispute arising out of the Contract which cannot be amicably settled between the parties shall be referred by either party to the arbitration and final decision of a person to be agreed between the parties. Failing agreement to concur in the appointment of an Arbitrator, the Arbitrator shall be appointed by the chairman of the Chartered Institute of Arbitrators, Kenya branch, on the request of the applying party.

## APPENDIX TO CONDITIONS OF CONTRACT

THE LAMU WATER AND SEWERAGE COMPANY IS

Name:

---

Address:

---

Name of Lamu Water and Sewerage Company's Representative:

---

Title; \_\_\_\_\_

Telephone: \_\_\_\_\_

The name (and identification number) of the Contract is \_\_\_\_\_

The Works consist of

---

---

The Start Date shall be

---

The Intended Completion Date for the whole of the Works shall be

---

The following documents also form part of the Contract:

---

---

The Site Possession Date shall be

---

The Site is located at \_\_\_\_\_ and is defined in drawings nos.

---

The Defects Liability Period is \_\_\_\_\_ days.

**TENDER NO. CGL/NDAU WATER SUPPLY/ONT/018/2019-2020**

**PAGE27**

Amount of Tender Security is Kshs..... (Note: This amount should be  
Between one (1) percent and three (3) percent of the value of the Works)

The name and Address of the County Government of Lamu for the purposes of submission  
of tenders  
is.....  
.....  
.....

The tender opening date and time is..... (*Insert tender opening time*) on  
..... day of ..... (*Insert date of tender opening*)

The amount of performance security is Kshs..... (Note: COUNTY  
GOVERNMENT OF LAMU must select the form of performance security to be accepted.  
A bank guarantee of between five (5) and ten (10) percent is acceptable. A performance  
bond on the other hand from an insurance company may be of up to thirty (30) percent of  
the Contract Price).

**NOTE:**

Included to this tender document are;

**1. Bills of quantities for NDAU water Supply Project**

## **SECTION IV – SPECIFICATIONS, DRAWINGS AND BILLS OF QUANTITIES/SCHEDULE OF RATES**

### **I. SPECIFICATIONS**

#### **Notes for preparing Specifications**

- 1.0 Specifications must be drafted to present a clear and precise statement of the required standards of materials and workmanship for tenderers to respond realistically and competitively to the requirements of COUNTY GOVERNMENT OF LAMU and ensure responsiveness of tenders. The Specifications should require that all materials, plant, and other supplies to be permanently incorporated in the Works be new, unused, of the most recent or current models and incorporating all recent improvements in designs and materials unless provided otherwise in the Contract.
- 2.0 Specifications from previous similar projects are useful and it may not be necessary to rewrite specifications for every works contract.
- 3.0 Care must be taken in drafting Specifications to ensure they are not restrictive. In the specification of standards for materials, plant and workmanship existing Kenya Standards should be used as much as possible otherwise recognized international standards may also be used.

### **II DRAWINGS**

- NOTE: 1. A list of the Contract Drawings should be inserted here
2. The actual Contract Drawings including Site plans should be annexed in a separate booklet

### **III BILL OF QUANTITIES/SCHEDULE OF RATES**

#### **Notes for preparing Bills of Quantities**

1. The objectives of the Bills of Quantities are;
  - (a) to provide sufficient information on the quantities of Works to be performed to enable tenders to be prepared efficiently and accurately; and
  - (b) when a Contract has been entered into, to provide a priced Bill of Quantities for use in the periodic valuation of Works executed.

In order to attain these objectives, Works should be itemized in the Bill of Quantities in sufficient detail to distinguish between the different classes of Works, or between Works of the same nature carried out in different locations or in other circumstances

which may give rise to different considerations of cost. Consistent with these requirements, the layout and content of the Bill of Quantities should be as simple and brief as possible.

#### **Notes for preparing Schedule of Rates**

Where the time limit or other constraints do not allow the preparation of a Bill of Quantities for the Works, a lump-sum Contract shall be adopted and a Schedule of Rates (in place of a Bills of Quantities) shall be issued as part of the tender documents.

The objectives of the Schedule of Rates are;

- (a) to provide sufficient information on the nature of work items to be performed to enable tenders to be prepared efficiently and accurately; and
- (b) when a Contract has been entered into, to provide a basis for the pricing of Works executed for interim and final valuations.

In order to attain these objectives, Works should be itemized in the Schedule of Rates in sufficient detail to distinguish between the different classes of Works, or between Works of the same nature carried out in different locations or other circumstances which may give rise to different considerations of cost. Consistent with these requirements, the layout and content of Schedule of Rates should be as simple and brief as possible.

Measurement of Work executed after every agreed stage should be done and the quantities so obtained used alongside the rates in the schedule to arrive at interim valuation [for each stage] and the final valuation.

***Evaluation criteria***

	<b>MADATORY REQUIREMENTS</b>	<b>POINTS</b>	
1.	<b>Particulars of the Tendering Company (Attach Copies)</b>  a) Certified copies of statutory documents as follows: - <ul style="list-style-type: none"> <li>• Certificate of incorporation/registration.</li> <li>• Current Tax Compliance certificate.</li> <li>• Valid NCA certificate category 8.</li> <li>• Valid and current trade/ Business license.</li> <li>• KRA Pin Certificate.</li> <li>• Attach site visit certificate.</li> <li>• Serialization of the document including the attachments.</li> </ul> b) Completed confidential business questionnaire and declaration form duly filled, signed and stamped. c) Disclosure of business ownership (Directors/ Partners /Sole Proprietor). Attach a copy Business CR 12 Form. d) Bidder to provide self-declaration that the person/tenderer is not debarred in the matter of the public procurement and asset disposal act 2015(As per section 62 of PPDA 2015). g) Bidder to provide self-declaration that the person/tenderer will not engage in any corrupt or fraudulent practice	<b>Mandatory</b>	
	<b>TECHNICAL/GENERAL REQUIREMENTS</b>		
2.	Provide details of; <ul style="list-style-type: none"> <li>• Company profile (state whether joint venture or not) (2 Marks).</li> <li>• contact person(s) ( 1 mark)</li> <li>• physical address/location ( 2 Marks)</li> </ul>	5	
3	Evidence of adequacy of working capital for this Contract <ul style="list-style-type: none"> <li>• Access to line(s) of credit (attach evidence 5 Marks).</li> <li>• Availability of other financial resources(attach evidence 5 Marks)</li> </ul>	10	
	Proof of Having undertaken at least 3 works of a similar nature in the last ten years. (Each @ 5 marks).).	15	
4	Bidder to provide a preliminary description of the proposed work; i.e. Method and schedule (5 marks). <ul style="list-style-type: none"> <li>• The drawings (5 marks).</li> <li>• The charts, as necessary (5 marks).</li> </ul>	15	
5	Documentary evidence for those submitting tenders for this works shall comprise of; <ul style="list-style-type: none"> <li>a) Equipment Data Sheet</li> <li>b) Performance charts,</li> <li>c) Work plan/schedule</li> </ul> (Each @ 5Marks)	15	

6	Qualifications and experience of key site management and technical personnel proposed for the assignment, at least a total of four officers for both site management and technical personnel (10 Marks) ( Attach Cvs.	10
7	Free from any litigation, current or during the last five years, in which the tenderer is involved. <b>(5 Marks)</b>	5
8	Well bound and serialized tender document. ( 5 Marks)	5
	<b>Total</b>	<b>80</b>

All information provided may be subject to confirmation by COUNTY GOVERNMENT OF LAMU providing false information will lead to disqualification. **NOTE:** Only tenders that score 60% out of 80% on technical evaluation will qualify to have their proposals for financials evaluated. Those scoring below 60% will be disqualified at this stage. Award will be given to the highest combined scorer.

### **Financial Evaluation**

The financial evaluation shall comprise 20% of the total marks

The formulae for determining the financial score (SF) shall be as follows;

$$SF = 20 FM/F$$

Where: SF is the financial score

FM is the lowest fees quoted and

F is the fees of the quotation under consideration.

The lowest fees quoted will be allocated the maximum score of 20%. The bidder with the combined highest technical and financial score shall be awarded the tender.



## SECTION V

### STANDARD FORMS

#### List of Standard Forms

(i)	Form of Invitation for Tenders.....	35
(ii)	Form of Tender.....	37
(iii)	Letter of Acceptance.....	39
(iv)	Form of Agreement.....	40
(v)	Form of Tender Security.....	42
(vi)	Performance Bank Guarantee.....	44
(vii)	Performance Bond.....	45
(viii)	Bank Guarantee for Advance Payment.....	49
(ix)	Qualification Information.....	51
(x)	Tender Questionnaire.....	55
(xi)	Confidential Business Questionnaire.....	56
(xi)	Details of Sub-Contractors.....	58
(xii)	Letter of Notification of Award.....	59
(xiii)	Request for Review Form.....	60

## FORM OF INVITATION FOR TENDERS

\_\_\_\_\_ [date]

To: \_\_\_\_\_ [name of Contractor]  
\_\_\_\_\_ [address]  
\_\_\_\_\_  
\_\_\_\_\_

Dear Sirs:

Reference: \_\_\_\_\_ [Contract Name]

You have been prequalified to tender for the above project.

We hereby invite you and other prequalified tenderers to submit a tender for the execution and completion of the above Contract.

A complete set of tender documents may be purchased by you from \_\_\_\_\_

\_\_\_\_\_ [mailing address, cable/telex/facsimile numbers].

Upon payment of a non-refundable fee of Kshs \_\_\_\_\_

All tenders must be accompanied by \_\_\_\_\_ number of copies of the same and a tender security in the form and amount specified in the tendering documents, and must be delivered to

\_\_\_\_\_ [address and location]

at or before \_\_\_\_\_ (time and date). Tenders will be opened immediately thereafter, in the presence of tenderers' representatives who choose to attend.

Please confirm receipt of this letter immediately in writing by cable/facsimile or telex.

Yours faithfully,

\_\_\_\_\_ Authorized Signature

\_\_\_\_\_ Name and Title

**TENDER NO. CGL/NDau WATER SUPPLY/ONT/018/2019-2020**

**PAGE34**

\_\_\_\_\_

## FORM OF TENDER

TO: \_\_\_\_\_ [Name of Lamu water and sewerage company) \_\_\_\_\_ [Date]  
\_\_\_\_\_ [Name of Contract]

Dear Sir,

1. In accordance with the Conditions of Contract, Specifications, for the execution of the above named works, we, the undersigned offer to undertake the above works and remedy any defects therein for the sum of  
Kshs. \_\_\_\_\_ [Amount in figures] Kenya  
Shillings \_\_\_\_\_ [Amount in words]
2. We undertake, if our tender is accepted, to commence the process as soon as is reasonably possible after the receipt of the COUNTY GOVERNMENT OF LAMU's Representative's notice to commence, and to complete the whole of the requirements comprised in the Contract within the time stated in the Appendix to Conditions of Contract.
3. We agree to abide by this tender until \_\_\_\_\_ [Insert date], and it shall remain binding upon us and may be accepted at any time before that date.
4. Unless and until a formal Agreement is prepared and executed this tender together with your written acceptance thereof, shall constitute a binding Contract between us.
5. We understand that you are not bound to accept the lowest or any tender you may receive.  
Dated this \_\_\_\_\_ day of \_\_\_\_\_ 20\_\_\_\_\_

Signature \_\_\_\_\_ in the capacity of \_\_\_\_\_  
duly authorized to sign tenders for and on behalf of  
\_\_\_\_\_ [Name of Tenderer] of  
\_\_\_\_\_ [Address of Tenderer]

Witness; Name \_\_\_\_\_

Address \_\_\_\_\_

Signature and Stamp \_\_\_\_\_

Date \_\_\_\_\_

(Amend accordingly if provided by Insurance Company)

**TENDER NO. CGL/ND AU WATER SUPPLY/ONT/018/2019-2020**

**PAGE35**

## LETTER OF ACCEPTANCE

\_\_\_\_\_ [date]

To: \_\_\_\_\_  
[name of the Contractor]

\_\_\_\_\_  
[address of the Contractor]

Dear Sir,

This is to notify you that your Tender dated \_\_\_\_\_ for  
the execution of \_\_\_\_\_  
[name of the Contract and identification number, as given in the Tender documents] for the Contract  
Price of Kshs. \_\_\_\_\_ [amount in figures]/[Kenya  
Shillings \_\_\_\_\_ (amount in words) ] in accordance with the  
Instructions to Tenderers is hereby accepted.

You are hereby instructed to proceed with the execution of the said Works in accordance with the  
Contract documents.

Authorized Signature .....

Name and Title of Signatory .....

Attachment : Agreement.

## FORM OF AGREEMENT

THIS AGREEMENT, made the \_\_\_\_\_ day of \_\_\_\_\_ 20 \_\_\_\_\_ between \_\_\_\_\_ of [or whose registered office is situated at] \_\_\_\_\_ (hereinafter called “County Government of Lamu”) of the one part AND \_\_\_\_\_ of [or whose registered office is situated at] \_\_\_\_\_ (hereinafter called “the Contractor”) of the other part.

WHEREAS THE Lamu Water and Sewerage Company is desirous that the Contractor executes

\_\_\_\_\_ (*name and identification number of Contract* ) (hereinafter called “the Works”) located at \_\_\_\_\_ [*Place/location of the Works*] and COUNTY GOVERNMENT OF LAMU has accepted the tender submitted by the Contractor for the execution and completion of such Works and the remedying of any defects therein for the Contract Price of Kshs \_\_\_\_\_ [*Amount in figures*], Kenya Shillings \_\_\_\_\_ [*Amount in words*].

NOW THIS AGREEMENT WITNESSETH as follows:

1. In this Agreement, words and expressions shall have the same meanings as are respectively assigned to them in the Conditions of Contract hereinafter referred to.
2. The following documents shall be deemed to form and shall be read and construed as part of this Agreement i.e.
  - (i) Letter of Acceptance
  - (ii) Form of Tender
  - (iii) Conditions of Contract Part I
  - (iv) Conditions of Contract Part II and Appendix to Conditions of Contract
  - (v) Specifications
  - (vi) Drawings
  - (vii) Priced Bills of Quantities/Priced Schedule of Rates [whichever is applicable]
3. In consideration of the payments to be made by COUNTY GOVERNMENT OF LAMU to the Contractor as hereinafter mentioned, the Contractor hereby covenants with COUNTY GOVERNMENT OF LAMU to execute and complete the Works and remedy any defects therein in conformity in all respects with the provisions of the Contract.

**TENDER NO. CGL/NDAU WATER SUPPLY/ONT/018/2019-2020**

**PAGE 37**

\_\_\_\_\_

4. COUNTY GOVERNMENT OF LAMU hereby covenants to pay the Contractor in consideration of the execution and completion of the Works and the remedying of defects therein, the Contract Price or such other sum as may become payable under the provisions of the Contract at the times and in the manner prescribed by the Contract.

IN WITNESS whereof the parties thereto have caused this Agreement to be executed the day and year first before written.

The common Seal of \_\_\_\_\_

Was hereunto affixed in the presence of \_\_\_\_\_

Signed Sealed, and Delivered by the said \_\_\_\_\_

Binding Signature of Lamu Water and Sewerage Company Limited  
\_\_\_\_\_

Binding Signature of Contractor \_\_\_\_\_

In the presence of (i) Name \_\_\_\_\_

Address \_\_\_\_\_

Signature \_\_\_\_\_

[ii] Name \_\_\_\_\_

Address \_\_\_\_\_

Signature \_\_\_\_\_

## FORM OF TENDER SECURITY

WHEREAS .....(hereinafter called “the Tenderer”) has submitted his tender dated ..... for the construction of

.....

..... (name of Contract)

KNOW ALL PEOPLE by these presents that WE ..... having our registered office at .....(hereinafter called “the Bank”), are bound unto .....(hereinafter called “Lamu Water and Sewerage Company”) in the sum of

Kshs..... for which payment well and truly to be made to the said COUNTY GOVERNMENT OF LAMU, the Bank binds itself, its successors and assigns by these presents sealed with the Common Seal of the said Bank this ..... Day of .....20.....

THE CONDITIONS of this obligation are:

1. If after tender opening the tenderer withdraws his tender during the period of tender validity specified in the instructions to tenderers  
Or
2. If the tenderer, having been notified of the acceptance of his tender by the COUNTY GOVERNMENT OF LAMU during the period of tender validity:
  - (a) fails or refuses to execute the form of Agreement in accordance with the Instructions to Tenderers, if required; or
  - (b) fails or refuses to furnish the Performance Security, in accordance with the Instructions to Tenderers;

We undertake to pay COUNTY GOVERNMENT OF LAMU up to the above amount upon receipt of his first written demand, without COUNTY GOVERNMENT OF LAMU having to substantiate his demand, provided that in his demand the COUNTY GOVERNMENT OF LAMU will note that the amount claimed by him is due to him, owing to the occurrence of one or both of the two conditions, specifying the occurred condition or conditions.

This guarantee will remain in force up to and including thirty (30) days after the period of tender validity, and any demand in respect thereof should reach the Bank not later than the said date.

\_\_\_\_\_  
[date]

\_\_\_\_\_  
[signature of the Bank]

\_\_\_\_\_  
[witness]

\_\_\_\_\_  
[seal]

**TENDER NO. CGL/NDau WATER SUPPLY/ONT/018/2019-2020**

**PAGE39**



## PERFORMANCE BANK GUARANTEE

To: \_\_\_\_\_ (County Government of Lamu) \_\_\_\_\_ (Date)  
\_\_\_\_\_ (Address of County Government of Lamu)

Dear Sir,

WHEREAS \_\_\_\_\_ (hereinafter called "the Contractor") has undertaken, in pursuance of Contract No. \_\_\_\_\_ dated \_\_\_\_\_ to execute \_\_\_\_\_ (hereinafter called "the Works");

AND WHEREAS it has been stipulated by you in the said Contract that the Contractor shall furnish you with a Bank Guarantee by a recognized bank for the sum specified therein as security for compliance with his obligations in accordance with the Contract;

AND WHEREAS we have agreed to give the Contractor such a Bank Guarantee:

NOW THEREFORE we hereby affirm that we are the Guarantor and responsible to you, on behalf of the Contractor, up to a total of Kshs. \_\_\_\_\_ (*amount of Guarantee in figures*) Kenya Shillings \_\_\_\_\_ (*amount of Guarantee in words*), and we undertake to pay you, upon your first written demand and without civil or argument, any sum or sums within the limits of Kenya Shillings \_\_\_\_\_ (*amount of Guarantee in words*) as aforesaid without your needing to prove or to show grounds or reasons for your demand for the sum specified therein.

We hereby waive the necessity of your demanding the said debt from the Contractor before presenting us with the demand.

We further agree that no change, addition or other modification of the terms of the Contract or of the Works to be performed thereunder or of any of the Contract documents which may be made between you and the Contractor shall in any way release us from any liability under this Guarantee, and we hereby waive notice of any change, addition, or modification.

This guarantee shall be valid until the date of issue of the Certificate of Completion.

SIGNATURE AND SEAL OF THE GUARANTOR \_\_\_\_\_

Name of Bank \_\_\_\_\_

Address \_\_\_\_\_

Date \_\_\_\_\_

(Amend accordingly if provided by Insurance Company)

**TENDER NO. CGL/NDAU WATER SUPPLY/ONT/018/2019-2020**

**PAGE40**



## PERFORMANCE BOND

By this Bond, We \_\_\_\_\_ of (or whose registered office is situated at] \_\_\_\_\_ as Principal (hereinafter called "the Contractor") and \_\_\_\_\_ of [or whose registered office is situated at] \_\_\_\_\_ as Surety (hereinafter called "the Surety"), are held and firmly bound unto \_\_\_\_\_ of [or whose registered office is situated at] \_\_\_\_\_ as Oblige (hereinafter called "County Government of Lamu") in the amount of Kshs. \_\_\_\_\_ [amount of Bond in figures] Kenya Shillings

[amount of Bond in words], for the payment of which sum well and truly, the Contractor and the Surety bind themselves, their heirs, executors, administrators, successors and assigns, jointly and severally, firmly by these presents.

WHEREAS the Contractor has entered into a Contract with the COUNTY GOVERNMENT OF LAMU dated the \_\_\_\_\_ day of \_\_\_\_\_ 20 \_\_\_\_\_ for the execution of \_\_\_\_\_ [name of Contract] in accordance with the Contract documents, Specifications and amendments thereto, which to the extent herein provided for, are by reference made part hereof and are hereinafter referred to as the Contract.

NOW THEREFORE, the Condition of this Obligation is such that, if the Contractor shall promptly and faithfully perform the said Contract (including any amendments thereto), then this obligation shall be null and void; otherwise it shall remain in full force and effect. Whenever the Contractor shall be, and declared by COUNTY GOVERNMENT OF LAMU to be, in default under the Contract, COUNTY GOVERNMENT OF LAMU having performed the COUNTY GOVERNMENT OF LAMU's obligations there under, the Surety may promptly remedy the default, or shall promptly:

- (1) complete the Contract in accordance with its terms and conditions; or
- (2) obtain a tender or tenders from qualified tenderers for submission to the COUNTY GOVERNMENT OF LAMU for completing the Contract in accordance with its terms and conditions, and upon determination by COUNTY GOVERNMENT OF LAMU and the Surety of the lowest responsive tenderer, arrange for a Contract between such tenderer and COUNTY GOVERNMENT OF LAMU and make available as work progresses (even though there should be a default or a succession of defaults under the Contract or Contracts of completion arranged under this paragraph) sufficient funds to pay the cost of completion less the balance of the Contract Price; but not exceeding, including other costs and damages for which the Surety may be liable hereunder, the amount set forth in the first paragraph hereof.

**TENDER NO. CGL/NDAU WATER SUPPLY/ONT/018/2019-2020**

**PAGE41**

The term "Balance of the Contract Price", as used in this paragraph, shall mean the total amount payable by COUNTY GOVERNMENT OF LAMU to the Contractor under the

Contract, less the amount properly paid by COUNTY GOVERNMENT OF LAMU to the Contractor; or

- (3) pay COUNTY GOVERNMENT OF LAMU the amount required by COUNTY GOVERNMENT OF LAMU to complete the Contract in accordance with its terms and conditions up to a total not exceeding the amount of this Bond.

The Surety shall not be liable for a greater sum than the specified penalty of this Bond.

Any suit under this Bond must be instituted before the expiration of one year from the date of issuance of the Certificate of Completion.

No right of action shall accrue on this Bond to or for the use of any person or corporation other than COUNTY GOVERNMENT OF LAMU named herein or the heirs, executors, administrators, successors and assigns of COUNTY GOVERNMENT OF LAMU.

In testimony whereof, the Contractor has hereunto set his hand and affixed his seal, and the Surety has caused these presents to be sealed with his corporate seal duly attested by the signature of his legal representative, this \_\_\_\_\_ day of \_\_\_\_\_ 20\_\_\_\_\_

SIGNED ON \_\_\_\_\_ SIGNED ON \_\_\_\_\_

On behalf of \_\_\_\_\_ On behalf of \_\_\_\_\_  
[name of Contractor] [name of Surety]

By \_\_\_\_\_ By \_\_\_\_\_

In the capacity of \_\_\_\_\_ In the capacity of \_\_\_\_\_

In the presence of;Name \_\_\_\_\_In the presence of;Name\_\_\_\_\_

Address\_\_\_\_\_

Address\_\_\_\_\_

Signature\_\_\_\_\_

Signature\_\_\_\_\_

Date\_\_\_\_\_

Date\_\_\_\_\_

## BANK GUARANTEE FOR ADVANCE PAYMENT

To: \_\_\_\_\_[*name of COUNTY GOVERNMENT OF LAMU*]  
\_\_\_\_\_(*Date*)  
\_\_\_\_\_[*address of COUNTY GOVERNMENT OF LAMU*]

Gentlemen,

Ref: \_\_\_\_\_[*name of Contract*]

In accordance with the provisions of the Conditions of Contract of the above-mentioned Contract, We, \_\_\_\_\_[*name and Address of Contractor*] (hereinafter called “the Contractor”) shall deposit with \_\_\_\_\_[*name of COUNTY GOVERNMENT OF LAMU*] a bank guarantee to guarantee his proper and faithful performance under the said Contract in an amount of Kshs. \_\_\_\_\_[*amount of Guarantee in figures*] Kenya Shillings \_\_\_\_\_[*amount of Guarantee in words*].

We, \_\_\_\_\_[*bank or financial institution*], as instructed by the Contractor, agree unconditionally and irrevocably to guarantee as primary obligator and not as Surety merely, the payment to \_\_\_\_\_[*name of COUNTY GOVERNMENT OF LAMU*] on his first demand without whatsoever right of objection on our part and without his first claim to the Contractor, in the amount not exceeding Kshs \_\_\_\_\_[*amount of Guarantee in figures*] Kenya Shillings \_\_\_\_\_[*amount of Guarantee in words*], such amount to be reduced periodically by the amounts recovered by you from the proceeds of the Contract.

We further agree that no change or addition to or other modification of the terms of the Contract or of the Works to be performed thereunder or of any of the Contract documents which may be made between \_\_\_\_\_[*name of COUNTY GOVERNMENT OF LAMU*] and the Contractor, shall in any way release us from any liability under this guarantee, and we hereby waive notice of any such change, addition or modification.

No drawing may be made by you under this guarantee until we have received notice in writing from you that an advance payment of the amount listed above has been paid to the Contractor pursuant to the Contract.

**TENDER NO. CGL/NDAU WATER SUPPLY/ONT/018/2019-2020**

**PAGE43**

This guarantee shall remain valid and in full effect from the date of the advance payment under the Contract until

\_\_\_\_\_ (*name of COUNTY GOVERNMENT OF LAMU*) receives full payment of the same amount from the Contract.

Yours faithfully,

Signature and Seal \_\_\_\_\_

Name of the Bank or financial institution \_\_\_\_\_

Address \_\_\_\_\_

Date \_\_\_\_\_

Witness:      Name: \_\_\_\_\_

Address: \_\_\_\_\_

Signature: \_\_\_\_\_

Date: \_\_\_\_\_

## QUALIFICATION INFORMATION

### 1. Individual Tenderers or Individual Members of Joint Ventures

1.1 Constitution or legal status of tenderer (attach copy or Incorporation Certificate);

Place of registration: \_\_\_\_\_

Principal place of business \_\_\_\_\_

Power of attorney of signatory of tender \_\_\_\_\_

1.2 Total annual volume of construction work performed in the last five years

Year	Volume	
	Currency	Value

1.3 Work performed as Main Contractor on works of a similar nature and volume over the last five years. Also list details of work under way or committed, including expected completion date.

Project name	Name of client and contact person	Type of work performed and year of completion	Value of performed and	Contract

1.4 Major items of Contractor's Equipment proposed for carrying out the Works. List all information requested below.

Item of Equipment	Description, Make and age (years)	Condition(new, good, poor) and number available	Owned, leased (from whom?), or to be purchased (from whom?)

**TENDER NO. CGL/NDAU WATER SUPPLY/ONT/018/2019-2020**

**PAGE45**

(etc.)			
--------	--	--	--

- 1.5 Qualifications and experience of key personnel proposed for administration and execution of the Contract. Attach biographical data.

Position	Name	Years of experience (general)	Years of experience in proposed position
Project Manager			
(etc.)			

- 1.6 Financial reports for the last five years: balance sheets, profit and loss statements, auditor's reports, etc. List below and attach copies.

\_\_\_\_\_  
 \_\_\_\_\_

- 1.7 Evidence of access to financial resources to meet the qualification requirements: cash in hand, lines of credit, etc. List below and attach copies of supportive documents.

\_\_\_\_\_  
 \_\_\_\_\_  
 \_\_\_\_\_

- 1.8 Name, address and telephone, telex and facsimile numbers of banks that may provide reference if contacted by the County Government of Lamu.

\_\_\_\_\_  
 \_\_\_\_\_

- 1.9 Statement of compliance with the requirements of Clause 1.2 of the Instructions to Tenderers.

**TENDER NO. CGL/NDAU WATER SUPPLY/ONT/018/2019-2020**

**PAGE46**

\_\_\_\_\_

---

---

---

1.10 Proposed program (work method and schedule) for the whole of the Works.

## **2Joint Ventures**

2.0 The information listed in 1.1 – 2.0 above shall be provided for each partner of the joint venture.

2.1 The information required in 1.11 above shall be provided for the joint venture.

2.2 Attach the power of attorney of the signatory (ies) of the tender authorizing signature of the tender on behalf of the joint venture

2.3 Attach the Agreement among all partners of the joint venture (and which is legally binding on all partners), which shows that:

- a) all partners shall be jointly and severally liable for the execution of the Contract in accordance with the Contract terms;
- b) one of the partners will be nominated as being in charge, authorized to incur liabilities and receive instructions for and on behalf of any and all partners of the joint venture; and
- c) the execution of the entire Contract, including payment, shall be done exclusively with the partner in charge.

## TENDER QUESTIONNAIRE

Please fill in block letters.

1. Full names of tenderer;  
.....
2. Full address of tenderer to which tender correspondence is to be sent (unless an agent has been appointed below);  
.....
3. Telephone number (s) of tenderer;  
.....
4. Telex of tenderer;  
.....
5. Name of tenderer's representative to be contacted on matters of the tender during the tender period;  
.....
6. Details of tenderer's nominated agent (if any) to receive tender notices. This is essential if the tenderer does not have his registered address in Kenya (name, address, telephone, telex);  
.....  
.....

\_\_\_\_\_  
Signature of Tenderer

Make copy and deliver to: \_\_\_\_\_ (*County Government of Lamu*)



## CONFIDENTIAL BUSINESS QUESTIONNAIRE

You are requested to give the particulars indicated in Part 1 and either Part 2 (a), 2 (b) or whichever applies to your type of business.

You are advised that it is a serious offence to give false information on this Form.

### *Part 1 – General*

Business Name .....

Location of business premises; Country/Town.....

Plot No..... Street/Road .....

Postal Address..... Tel No.....

Nature of Business.....

Current Trade Licence No..... Expiring date.....

Maximum value of business which you can handle at any time: K. pound.....

Name of your bankers.....

Branch.....

### *Part 2 (a) – Sole Proprietor*

Your name in full..... Age.....

Nationality..... Country of Origin.....

Citizenship details .....

Signature and Stamp.....

### *Part 2 (b) – Partnership*

*Give details of partners as follows:*

	<i>Name in full</i>	<i>Nationality</i>	<i>Citizenship Details</i>	<i>Shares</i>
1	.....	.....	.....	.....
2	.....	.....	.....	.....
3	.....	.....	.....	.....

**Date.....Signature/Company Seal.....**

## DETAILS OF SUB-CONTRACTORS

If the Tenderer wishes to sublet any portions of the Works under any heading, he must give below details of the sub-contractors he intends to employ for each portion.

Failure to comply with this requirement may invalidate the tender.

(1) Portion of Works to be sublet: .....

[i] Full name of Sub-contractor  
and address of head office: .....  
.....

(ii) Sub-contractor's experience  
of similar works carried out in  
the last 3 years with  
Contract value: .....  
.....  
.....

(2) Portion of Works to sublet: .....

[i] Full name of sub-contractor  
and address of head office: .....  
.....

[ii] Sub-contractor's experience of similar works carried out in the last 3 years with  
contract value: .....  
.....

\_\_\_\_\_  
[Signature of Tenderer)

\_\_\_\_\_  
Date

## LETTER OF NOTIFICATION OF AWARD

Address of County Government of Lamu

\_\_\_\_\_  
\_\_\_\_\_

To: \_\_\_\_\_  
\_\_\_\_\_  
\_\_\_\_\_  
\_\_\_\_\_

RE: Tender No. \_\_\_\_\_

Tender Name \_\_\_\_\_

This is to notify that the contract/s stated below under the above mentioned tender have been awarded to you.

\_\_\_\_\_  
\_\_\_\_\_

1. Please acknowledge receipt of this letter of notification signifying your acceptance.
2. The contract/contracts shall be signed by the parties within 30 days of the date of this letter but not earlier than 14 days from the date of the letter.
3. You may contact the officer(s) whose particulars appear below on the subject matter of this letter of notification of award.

(*FULL PARTICULARS*) \_\_\_\_\_  
\_\_\_\_\_

SIGNED FOR MANAGING DIRECTOR

FORM RB 1

**TENDER NO. CGL/NDAU WATER SUPPLY/ONT/018/2019-2020**

**PAGE51**

\_\_\_\_\_

**REPUBLIC OF KENYA**  
**PUBLIC PROCUREMENT ADMINISTRATIVE REVIEW BOARD**

APPLICATION NO.....OF.....20.....

BETWEEN

.....APPLICANT

AND

.....RESPONDENT (*COUNTY GOVERNMENT OF LAMU*)

Request for review of the decision of the..... (*Name of COUNTY GOVERNMENT OF LAMU*) of  
.....dated the...day of .....20.....in the matter of Tender No.....of  
.....20...

**REQUEST FOR REVIEW**

I/We.....,the above named Applicant(s), of address: Physical  
address.....Fax No.....Tel. No.....Email ....., hereby request the Public  
Procurement Administrative Review Board to review the whole/part of the above mentioned decision on the  
following grounds, namely:-

- 1.
2. etc.

By this memorandum, the Applicant requests the Board for an order/orders that: -

- 1.
2. etc

SIGNED .....(Applicant)

Dated on.....day of ...../...20...

---

**FOR OFFICIAL USE ONLY**

Lodged with the Secretary Public Procurement Administrative Review Board on ..... day of  
.....20.....

SIGNED  
Board Secretary

**TENDER NO. CGL/ND AU WATER SUPPLY/ONT/018/2019-2020**

**PAGE52**

**APPENDIX II.**

**THE BILL OF QUANTITIES FOR NDAU WATER SUPPLY PROJECT**

Bill of Quantity For Siyu Village

---



**BILL OF QUANTITIES  
FOR  
NDAU WATER SUPPLY  
PROJECT**

ITEM NO.	DESCRIPTION	UNIT	QUANTITY	RATE	AMOUNT KSHS
<b><u>A.</u></b>	<b><u>CONSTRUCTION OF 8.305KM PIPELINE</u></b>				
	<b><u>Clearing of pipeline route</u></b>				
1.0	Clear pipeline route of bushes, undergrowth, trees, debris and rubbish and dispose. Width of clearance to be 2.0m to accommodate for access road and trench and excavation of materials.	M <sup>2</sup>	1,850		
	<b><u>Excavation</u></b>				
1.1	Excavate for pipe trench to a depth not exceeding 1000mm for 80mm diameter Pvc pipes class D, prepare bed on completion of excavation.	M	925		
1.2	Excavate for pipe trench to a depth not exceeding 1000mm for 50mm diameter Pvc pipes class D, prepare bed on completion of excavation.	M	680		
1.3	Excavate for pipe trench to a depth not exceeding 1000mm for 25mm diameter Pvc pipes class D, prepare bed on completion of excavation.	M	1,000		
1.4	Excavate for pipe trench to a depth not exceeding 1000mm for 20mm diameter Pvc pipes class D, prepare bed on completion of excavation.	M	3,000		
1.5	Excavate for pipe trench to a depth not exceeding 1000mm for 20mm diameter PPR pipes class D, prepare bed on completion of excavation.	M	2,700		

	<b><i>SUB-TOTAL</i></b>				

ITEM NO.	DESCRIPTION	UNIT	QUANTITY	RATE	AMOUNT KSHS
	<b><i>Balance Brought Forward</i></b>				
1.6	<b><u>Laying and jointing of pvc pipes.</u></b> Distribute, lay and joint 80mm diameter Pvc pipes class D in trench including making provisions for appurtenances and pipe fittings as per specifications.	M	925		
1.7	Distribute, lay and joint 50mm diameter Pvc pipes class D in trench including making provisions for appurtenances and pipe fittings as per specifications.	M	680		
1.8	Distribute, lay and joint 25mm diameter Pvc pipes class D in trench including making provisions for appurtenances and pipe fittings as per specifications.	M	1,000		
1.9	Distribute, lay and joint 20mm diameter Pvc pipes class D in trench including making provisions for appurtenances and pipe fittings as per specifications.	M	3,000		
2.0	Distribute, lay and joint 20mm diameter PPR pipes for meter installation.	M	2,700		
	<b><i>SUB-TOTAL</i></b>				



ITEM NO.	DESCRIPTION	UNIT	QUANTITY	RATE	AMOUNT KSHS
	<b><i>Balance Brought Forward</i></b>				
2.1	<b><u>Backfilling</u></b> Backfill trench using well selected excavated material after laying and jointing the 80mm, 50mm, 25mm and 20mm PVC and PPR pipes.	M	8,305		
2.2	<b><u>Installation of Consumer Water Meters</u></b> Distribute and install No.576 of 15mm Kent Water Meters as directed by the Engineer.	No.	576		
2.3	<b><u>Road crossing</u></b> Allow for provision of road crossing; culvert construction and casing for PVC pipes.	Lump sum	1		
2.4	<b><u>Construction of valve chambers</u></b> Construct standard reinforced concrete valve chambers. Include for hardcore fill, boxing out for manhole and fixing of 1No. MS manhole cover and frame light duty 600x 450mm for water master meters, air valves and washout.	No.	3		
2.5	<b><u>Pressure Testing &amp; Disinfection.</u></b> Allow for carrying out pressure testing on pipeline.	M	1,605		
2.6	<b><u>Installation of Air Valves, Wash out and Water Master Meters.</u></b> Install rising air valves wash out and water master meters and connect to pipeline as instructed on site.	No.	3		

**TENDER NO. CGL/ND AU WATER SUPPLY/ONT/018/2019-2020**

**PAGE57**

	<b><i>SUB-TOTAL</i></b>				

ITEM NO.	DESCRIPTION	UNIT	QUANTITY	RATE	AMOUNT KSHS
	<b><i>Balance Brought Forward</i></b>				
2.7	<b><u>INSTALLATION OF AIR VALVES, WASH OUT AND WATER METERS</u></b> Provide and install 2" water meters at inter connection of the 80mm diameter PVC Pipeline.	No.	3		
2.8	<b><u>CONSTRUCTION OF INTERCONNECTION CHAMBERS.</u></b> Supply all materials, construct chambers for interconnection of the gravity main of 80mm diameter and the extension distribution mains of 50mm	No.	5		
2.9	Install and connect to pipeline sluice valve and all other fittings.	No.	3		
3.0	<b><u>Miscellaneous</u></b> Provide concrete class 15 include for the required formwork and additional excavation for anchor blocks and surrounding of pipeline as directed by the Engineer (Provisional).	No.	10		
3.1	<b><u>MARK POST</u></b> Provide, lay and fix in place and paint pre-cast reinforced concrete marker posts along the pipeline at 200m interval, the posts to be with letter 100mm, 80mm and 50mm posts be painted blue. The size to be 75mm x100mm x 150mm long.	No.	18		

	<b><i>SUB-TOTAL</i></b>				
--	-------------------------	--	--	--	--

ITEM NO.	DESCRIPTION	UNIT	QUANTITY	RATE	AMOUNT KSHS
	<b><i>Balance Brought Forward</i></b>				
	<b><u>MATERIALS FOR PIPELINE.</u></b>				
1.	PVC 80mm Diameter pipes class D	No.	155		
2.	PVC 50mm Diameter pipes class D	No.	114		
3.	PVC 25mm Diameter pipes class D	No.	167		
4.	PVC 20mm Diameter pipes class D	No.	650		
5.	PPR 20mm Diameter pipes class D	No.	450		
6.	2" PVC Tee	No.	20		
7.	1" PVC Tee	No.	168		
8.	3/4" PVC Tee	No.	150		
9.	3" x 2" PVC Reducing socket	No.	4		
10.	2" x 1" PVC Reducing socket	No.	100		
11.	1" x 3/4" PVC Reducing socket	No.	100		
12.	2" Gate valve	No.	3		
13.	1" Gate valve	No.	50		
14.	3/4" Gate valve	No.	900		
15.	3/4" G.I Elbow	No.	750		
16.	3/4" G.I Bend	No.	900		
	<b><i>SUB-TOTAL</i></b>				

**TENDER NO. CGL/NDau WATER SUPPLY/ONT/018/2019-2020**

**PAGE59**

[illegible]

**TENDER NO. CGL/NDAU WATER SUPPLY/ONT/018/2019-2020**

**PAGE60**

ITEM NO.	DESCRIPTION	UNIT	QUANTITY	RATE	AMOUNT KSHS
	<i>Balance Brought Forward</i>				
	<b><u>MATERIALS FOR VALVE CHAMBERS.</u></b>				
1.	Water meter 3" (Kent) Flanged	No.	1		
2.	Water meter 2" Flanged	No.	4		
3.	Air valve 3" Female screwed	No.	3		
4.	Wash out valve 3" Flanged	No.	1		
5.	Air valve 2" Female screwed	No.	3		
6.	Gate valve 2" U.K	No.	3		
7.	G.I Nipple 2"	No.	10		
8.	G.I Plain socket 2"	No.	15		
9.	G.I Tee 2"	No.	5		
10.	G.I Tee Flanged 3" (both sides)	No.	3		
11.	G.I Plain socket 3"	No.	6		
12.	PVC Adaptor 3"	No.	22		
13.	G.I Nipple 3"	No.	10		
	<b><i>SUB-TOTAL</i></b>				

ITEM NO.	DESCRIPTION	UNIT	QUANTITY	RATE	AMOUNT KSHS
	<b><i>Balance Brought Forward</i></b>				
14.	G.I Flange 3"	No.	12		
15.	PVC Reducing Socket 3" x 2"	No.	3		
16.	Bolts, Nuts and Washers of 16mm Diameter of 3" length	No.	32		
17.	Bolts, Nuts and Washers of 10mm Diameter of 3" length	No.	32		
18.	Gaskets 6mm thickness	Kg	8		
19.	PVC Adaptors 2"	No.	12		
20.	G.I Nipple 2"	No.	20		
21.	Cast iron lockable manhole cover	No.	5		
22.	Solfix cement	LTR.	16		
23.	Coral Blocks 9" x 9" x 16"	No.	1,000		
24.	Portland Cement	Bag.	40		
25.	Building Sand	M <sup>3</sup>	11		
26.	Ballast	No.	22		
	<b><i>PIPELINE TOTAL</i></b>				



ITEM NO.	DESCRIPTION	UNIT	QUANTITY	RATE	AMOUNT KSHS
<b>B.</b>	<b><u>FABRICATION AND INSTALLATION OF 50M<sup>3</sup> STEEL ELEVATED TANK.</u></b>				
1.0	<b><u>Excavation and earthworks.</u></b> Excavate for foundation to a depth not exceeding 1500mm.	Item	1		
1.2	<b><u>Tank construction</u></b> Construct a 50m <sup>3</sup> METRIC COLD Pressed Steel Sectional Water Storage Tank of size 5000mm x 5000mm x 2000mm to BS 1564 Part II complete with 1.5mm thick pitched roof cover, Internal & External ladders, Water Level Indicator, Vent Cleats, Stays, Manhole with lockable cover, Glasticord joining compound, galvanized nuts, bolts & washers. Tank painted with 2 coats Bituprime internally & Aluminium paint externally – Plate thickness 4.5mm.	No.	1		
1.3	Provide 15m high Tank tower to BS 449 complete with walk way, hand rail, ladder painted with 2 coat of Aluminium paint.	No.	1		
1.4	Fabricate and erection of structural steel work for 27m steel tower.	Item	1		
1.5	Allow for piping costs and transportation to site.	Item	1		
	<b><i>ELEVATED TANK TOTAL</i></b>				



ITEM NO.	DESCRIPTION	UNIT	QUANTITY	RATE	AMOUNT KSHS
<b>C.</b>	<b><u>CONSTRUCTION OF PLANT HOUSE.</u></b>				
1.0	Clear site of all bushes, scrubs, undergrowth and trees and remove all stumps and roots and dispose.	Lump Sum	1		
1.1	Excavate site commencing from 200mm below ground level but not exceeding 1.0m deep.	M <sup>3</sup>	15		
1.2	Provide, place 50mm thick blinding 1:3:6 concrete mix to the strip foundation.	M <sup>2</sup>	2		
1.3	Provide, place and joint 200mm thick dressed coral stone house wall in 1:3 cement sand mortar as directed by the engineer.	M <sup>2</sup>	108		
1.4	Provide, place and compact 200mm thick hardcore for backfilling as shown on the drawings.	M <sup>2</sup>	50		
1.5	Provide, place 50mm thick blinding 1:3:6 concrete mix on top of hardcore and compact.	M <sup>2</sup>	50		
1.6	Provide, mix and place 100mm thick vibrated reinforced concrete 1:2:4 mix to floor slab. Allow for curing.	M <sup>3</sup>	6		
1.7	Provide, mix and place 1:3 cement sand screed 20mm thick on top of floor slab. Allow for curing.	M <sup>2</sup>	50		
	<b>TOTAL</b>				

ITEM NO.	DESCRIPTION	UNIT	QUANTITY	RATE	AMOUNT KSHS
	<b><i>Balance Brought Forward</i></b>				
1.8	Provide, prepare and apply 1:3 cement sand plaster of 20mm thick to internal sides of wall. Allow for water proof cement and curing.	M <sup>2</sup>	90		
1.9	Provide, prepare and apply 1:3 cement sand plaster of 20mm thick to external sides of wall. Allow for curing.	M <sup>2</sup>	95		
	<b><u>Reinforcement</u></b>				
2.0	Provide and fix Y10 reinforcement bars in concrete beam of plant house as shown on drawings directed by engineer.	M	255		
2.1	Provide and fix Y8 reinforcement bars for links in concrete beams of the house as shown on the drawing.	M	274		
	<b><u>Sundries</u></b>				
2.2	Provide, mix and place reinforced concrete 1:2:4 to beam as shown on the drawings. Allow for plastering. The column size to be 200 x 200mm.	No.	8		
2.3	Allow for roof placement	Item	1		
	<b>TOTAL</b>				

SUMMARY OF BILL OF QUANTITIES FOR NDAU PROJECT.		
BOQ ITEM.	DESCRIPTION	AMOUNT (Kshs)
A	Construction of 8.305Km Pipeline	
B	Installation of 15m Elevated Tank	
C	Construction of Plant House	
	<b><i>SUB-TOTAL</i></b>	
	Contingencies (5%)	
	Branding	50,000
	<b>GRAND TOTAL (Inclusive of VAT)</b>	

**Notes:**

- Total Household in Ndau is 221
- Total Population in Ndau is 1,070
- There is an existing RO plant installed by CDF with a capacity of 0.8m<sup>3</sup>/hr.
- The county government is installing another desalination plant of 5m<sup>3</sup>/hr
- The two desalination plant will produce a total of 5.8m<sup>3</sup>/hr.

**PROFILE DRAWINGS  
FOR  
NDAU WATER SUPPLY  
PROJECT**



MINISTRY OF ENVIRONMENT WATER  
AND NATURAL RESOURCES  
COUNTY GOVERNMENT OF LAMU

Project KIUNGA WATER PROJECT  
[ Lamu East Sub County]

Drawing title

Longitudinal profile from  
proposed tank to Ndau  
primary

Prepared By: J/k. Gitau

Checked By: C Engineer/ Jacob

LAWASCO Director: Sign

Date: 10-7-2018

Date: 16-7-2018

Date: 16-7-2018

Scale(s)

Drg.no KUM/07/18-05

Date July, 2018

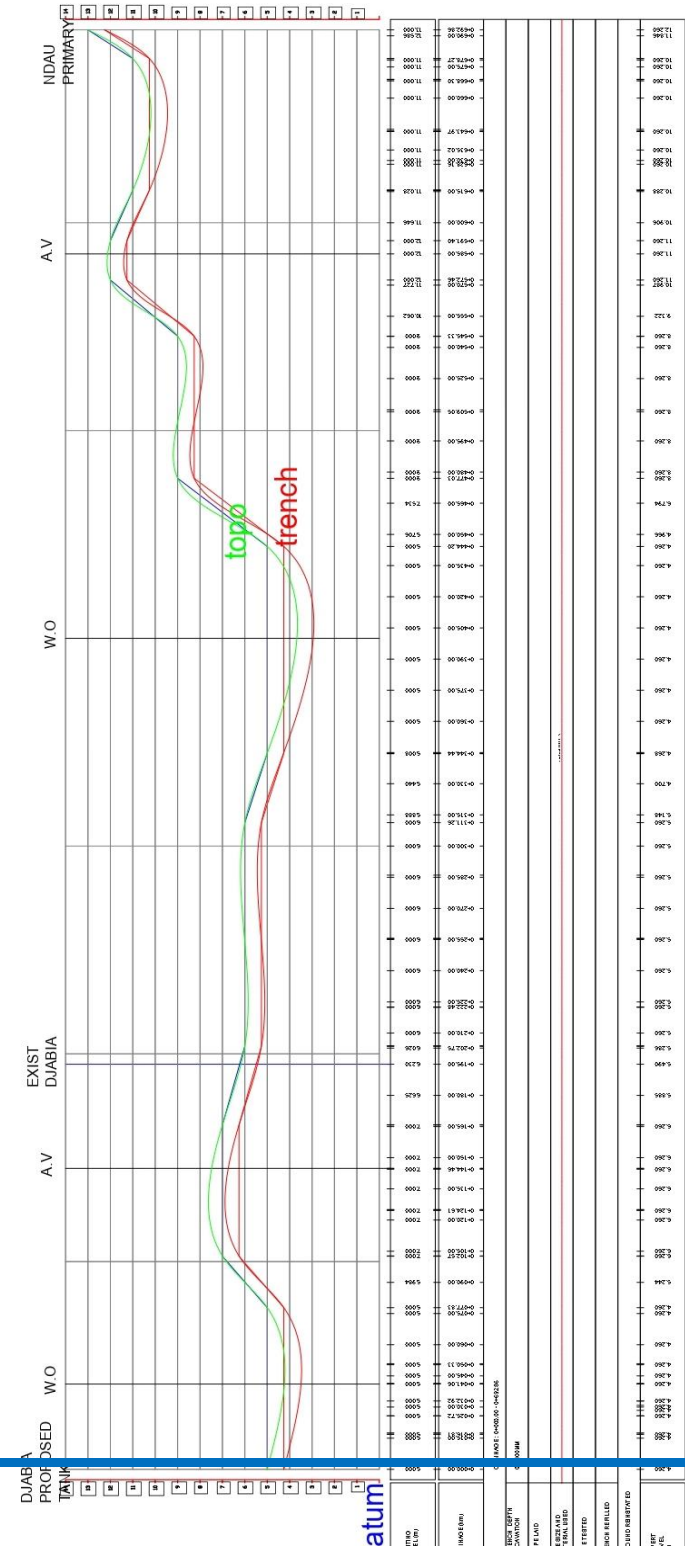



MINISTRY OF ENVIRONMENT WATER  
AND NATURAL RESOURCES  
COUNTY GOVERNMENT OF LAMU

Project KIUNGA WATER PROJECT  
[ Lamu East Sub County]

Drawing title

Longitudinal profile from  
proposed tank to Ndau  
primary

Prepared By: J.L. Clau

Date: 10-7-2018

Sign

Checked By: C. Engineer / Jacob

Date: 16-7-2018

Sign

LAWASCO Director: Sign

Date: 16-7-2018

Scale(s)

Drng no  
Kum/07/18-05

Date  
July 2018

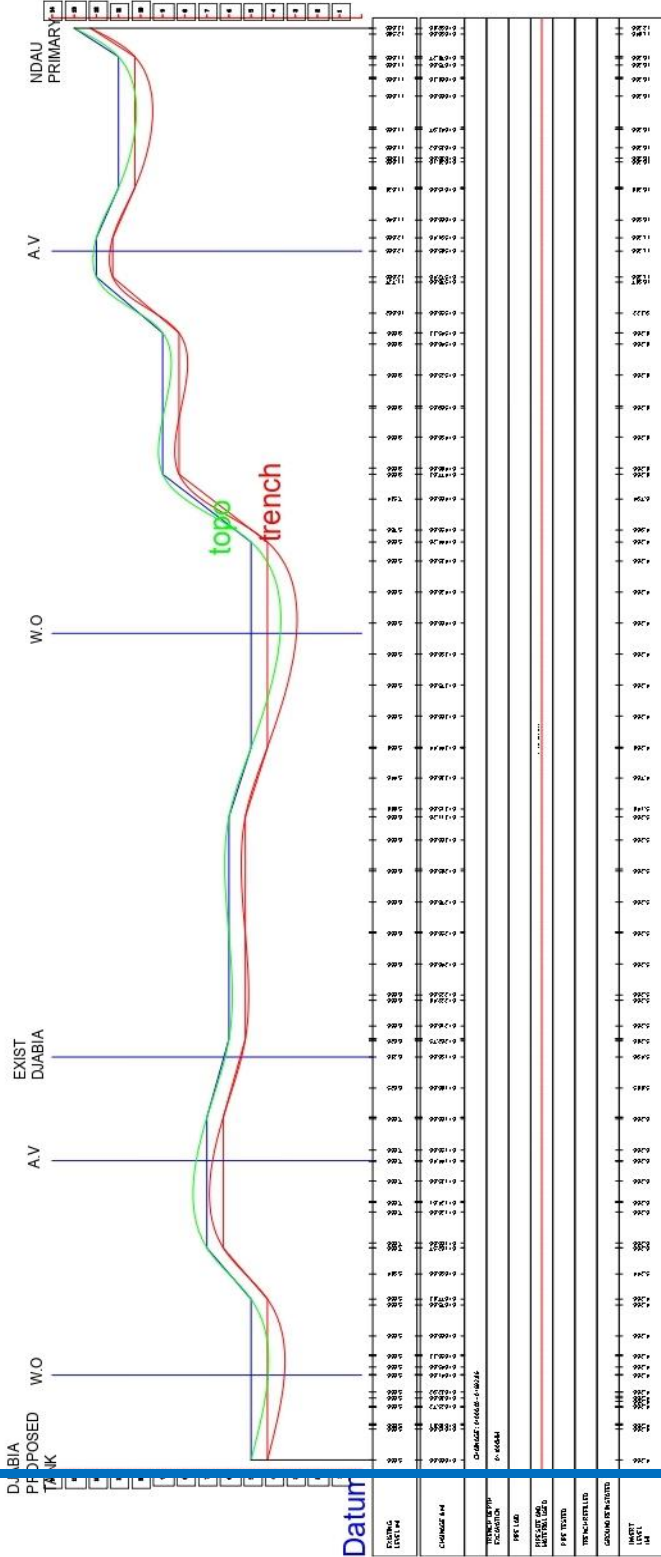



**ELEVATED TANK  
FOR  
NDAU WATER SUPPLY  
PROJECT**



**PLANT HOUSE  
FOR  
NDAU WATER SUPPLY  
PROJECT**

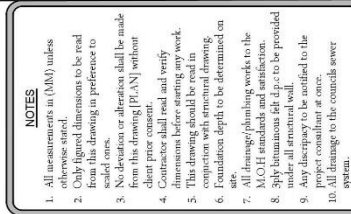

**CLIENT:**  
LAWU WATER & SEWERAGE CO. LTD.

**PROJECT:**  
PROPOSED NDAU PLANT HOUSE

**Checked by:**  
Mr. Jacob M. Chizipila

**Signed by M.D.:**  
Mr. Paul K. Wainanga

**TITLE:** Working Drawing  
Plans, Elevations,  
Section & Details

DATE : AUGUST 2018 DRG. No.  
SCALE: AS SHOWN  
DESIGN BY: D.M.Baya C7236C1208

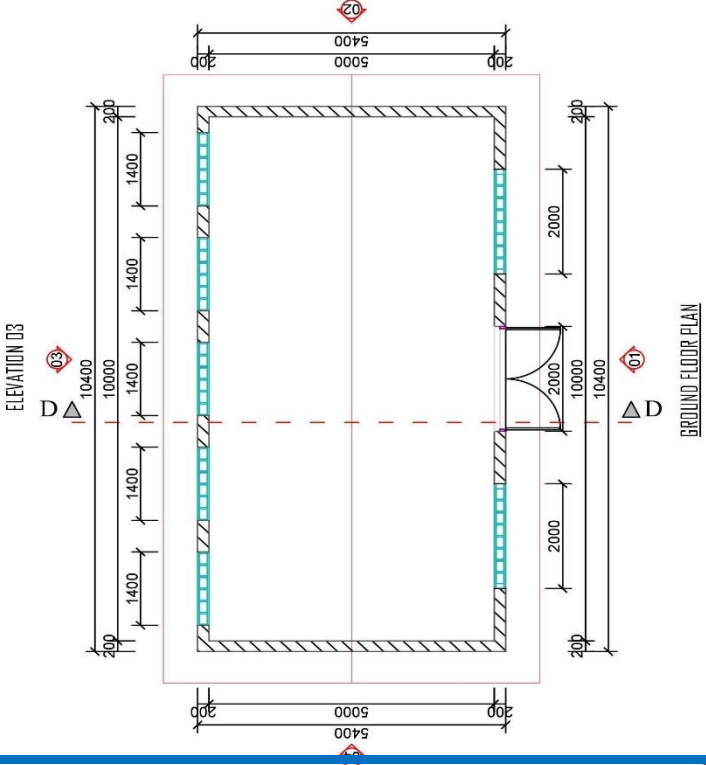
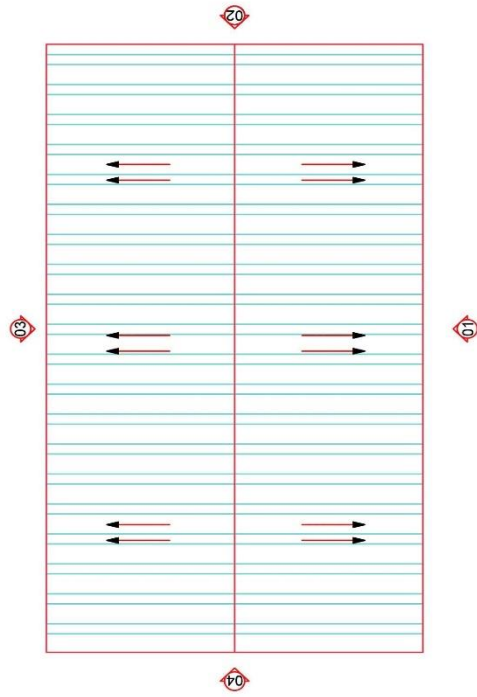



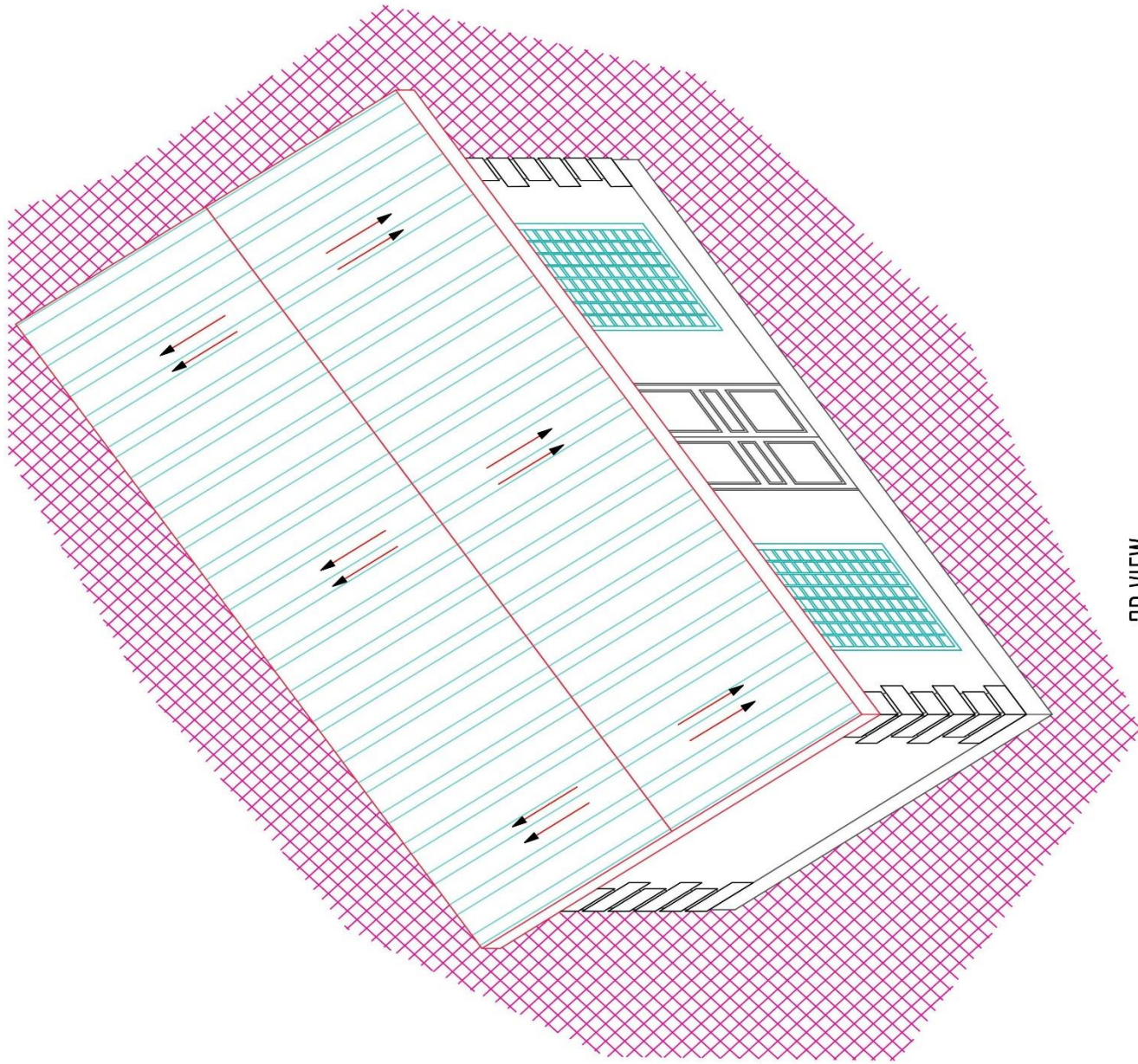

3D VIEW

NOTES

1. All measurements in (MM) unless otherwise stated.
2. Only figured dimensions to be read from this drawing in preference to scaled ones.
3. No deviation or alteration shall be made from this drawing (PLAN) without written permission of the Engineer.
4. Contractors shall read and verify dimensions before starting any work.
5. This drawing should be read in conjunction with structural drawing.
6. Foundation depth to be determined on site.
7. All drainage/plumbing works to the MCHH standard and satisfaction.
8. Any dimensions if not to be provided shall be as per standard.
9. Any discrepancy to be notified to the project consultant at once.
10. All drainage to the council sewer system.

**CLIENT:**  
LARIU WATER & SEWERAGE CO. LTD

**PROJECT:**  
PROPOSED NDAU PLANT HOUSE

**Checked by:**  
Mr. Jacob M. Chirizphi

**Signed by A.D:**  
Mr. Paul K. Wairara

**TITLE:**  
Working Drawing  
ANCONOMETRY 3D VIEW

DATE : AUGUST 2018 DRG. No.  
SCALE: AS SHOWN  
DESIGN BY: D.A. Moya C7256/1208